

Part List

Control unit

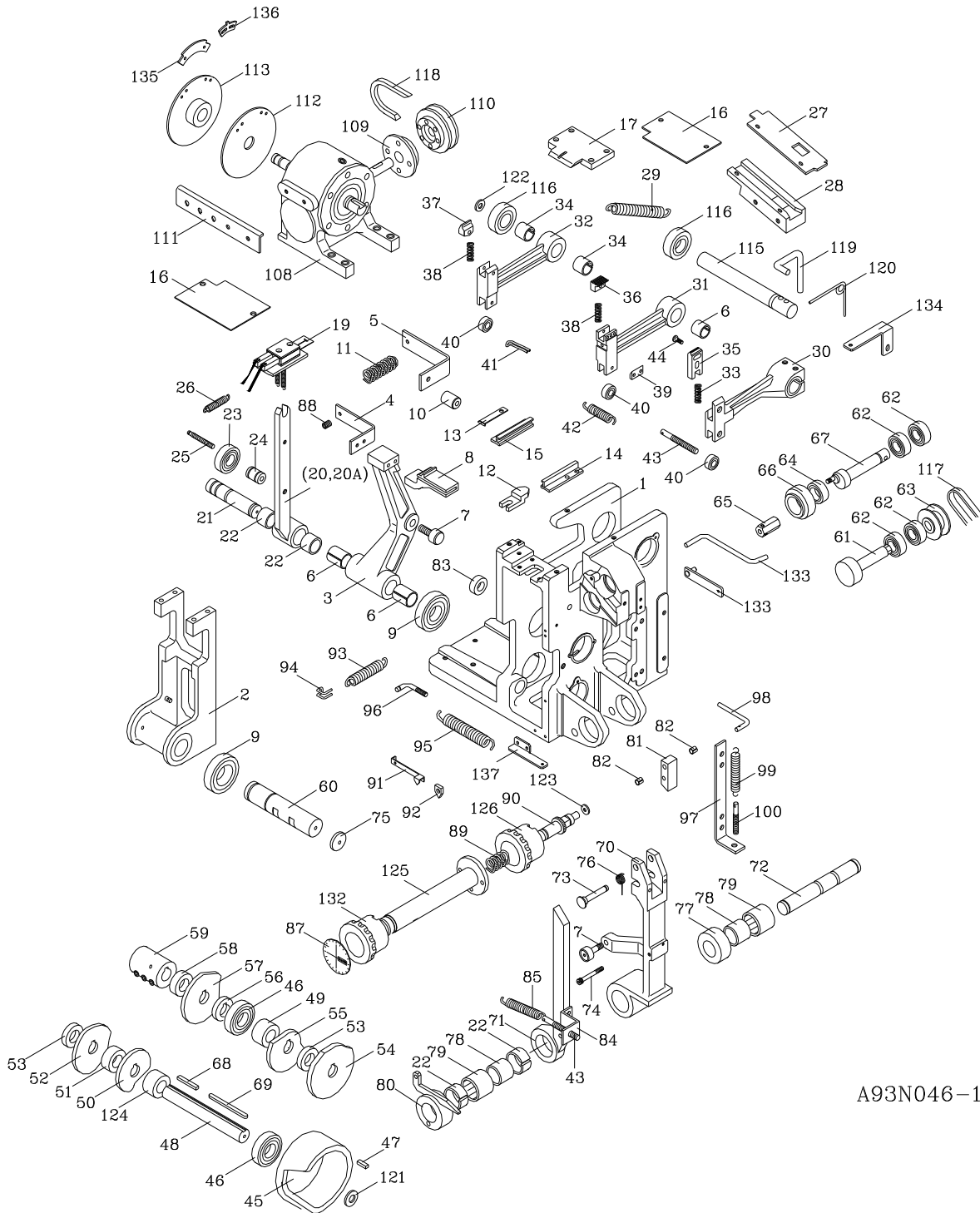

A93N046-1

7.1

Control unit

No.	Part No.	Part Name	Q'Ty
1	A20-150001	Control Frame	1
2	A20-123050	Slide Table Frame	1
3	A20-121001	Band Guide Arm	1
4	A20-120008	Flap Connecting Spring Bracket	1
5	A20-122002	Band Guide Spring Bracket	1
6	G01-202325	Metal Bush, MB2025	3
7	G07-221210	Cam Follower, KR22xLL	2
8	A20-120007	Band Guide	1
	A20-120007AAA	Band Guide (short feeding system with alarm)	1
9	G04-216304	Ball Bearing, 6304ZZ	2
10	A20-120004-1	Slide Table Back Adjuster	1
11	A20-122001	Band Guide Spring	1
12	A20-150002-1	Band Width Block	1
13	A20-140007	Heater Stopper	1
14	A20-140004	Heater Slider Guide (A)	1
15	A20-140003	Heater Slider Guide (B)	1
16	A93N-150003-0	Slide Table Cover	2
17	A20-120003-2CAA	Slide Table (9mm)	1
	A20-120003-2DAA	Slide Table (12mm)	1
	A20-120003-2EAA	Slide Table (15mm)	1
19	A20-143000N	Heater Set	1
	A11-141000-1	Heater Set (Conventions)	1
20	A11-142150-1	Heater Crank	1
21	A20-140005	Heater Crank Shaft	1
22	G01-202315	Metal Bush MB2015	4
23	G04-216304	Ball Bearing, 6304ZZ	1
24	A20-142003	Heater Crank Collar	1
25	A20-142002	Heater Bearing Shaft	1
26	A20-140002	Heater Crank Spring	1
27	A20-171008	Feed Shooter Cover	1
28	A20-171007-1CAA	Feed Shooter (9mm)	1
	A20-171007-1DAA	Feed Shooter (12mm)	1
	A20-171007-1EAA	Feed Shooter (15mm)	1
	A20-171013-0CAA	Feed Shooter (9mm) (30Strapping/minute)	1
	A20-171013-0DAA	Feed Shooter (12mm) (30Strapping/minute)	1
	A20-171013-0EAA	Feed Shooter (15mm) (30Strapping/minute)	1
29	A20-130005	Press Tension Spring	3
30	A20-131001	RH, Block Arm	1
31	A20-132001	Center Block Arm	1
32	A20-133001	LH. Block Arm	1

No.	Part No.	Part Name	Q'Ty
33	A20-131004	RH. Block Spring	1
34	G01-202320	Metal Bush, MB2020	2
35	A20-131005-0	Cutter Upper	1
	A20-131002-0FAA	Cutter Upper 19mm	1
	A20-131005-0K	Cutter Upper (30Strapping/minute) SKD-11	1
	A20-131002-2K	Cutter Upper SKD-11	1
36	A20-132002	Universal Press	1
37	A20-133002	Jaw Left	1
38	A20-132005	LH & Center Block Spring	2
39	A20-132003-1	Cutter Lower	1
40	G04-210628	Ball Bearing, 628ZZ	3
41	A20-132004	Cutter Spring Hook	1
42	A20-130006	Cutter Tension Spring	1
43	A20-130002	Cutter Tension Spring Hook	2
44	A20-131003-1	Cutter Upper Pin	1
45	A20-110001	Tension Cam	1
	A20-110001T	Tension Cam(30 Strapping/minute)	1
46	G04-216205	Ball Bearing, 6205ZZ	2
47	W37-070720	Key, 7x7x20 (Square)	2
48	A20-111006	Cam Shaft	1
49	A20-111008-1	Collar 28.8x34x28.3	1
50	A20-111002	RH Press Cam	1
51	A20-111009	Collar 28.8x34x20	1
52	A20-111015-2	Center Press Cam	1
	A20-111003-1	Center Press Cam (Conventions Heater Plate Type)	1
53	A20-111010	Collar 28.8x34x8	2
54	A20-111004	Heater Cam	1
55	A20-111005	LH. Press Cam	1
56	A20-111011	Collar 28.8x34x5.5	1
57	A20-111001	Slide Table Cam	1
58	A20-111012	Collar 28.8x34x14	1
59	A20-111007	Cam Shaft Coupling	1
60	A20-120002	Slide Table Frame Shaft	1
61	A20-171201	Feed Roller	1
62	G04-216202(K1930140154)	Ball Bearing, 6202ZZ	4
63	A20-171006	Feed Roller Pulley (50/60HZ)	1
	A93-171008-1	Feed Roller Pulley (30 Strapping/minute)(1Ph)	1
64	G04-210628	Ball Bearing, 628ZZ	1
65	A20-171005-1	Lever Holder	1
	A20-171011-0	Lever Holder (Standard)	1

No.	Part No.	Part Name	Q'Ty
66	A20-171103-0CAA	Feed Upper Roller (9mm)	1
	A20-171103-0DAA	Feed Upper Roller (12mm)	1
	A20-171103-0EAA	Feed Upper Roller (15mm)	1
67	A20-171003	Feed Upper Roller Shaft	1
68	W37-070748	Key 7x7x48 (Square)	1
69	W35-070790	Heater & Press Cam Key 7x7x90	1
70	A20-161001	Tension Arm	1
71	A20-165150	Tension Adjust Arm	1
72	A20-160001	Tension Arm Shaft	1
73	A20-161002	Tension jaw Shaft	1
74	A20-161003	Tension Arm Spring Hook	1
75	A20-120010	End Plate	1
76	A20-161004	Tension Jaw Spring	1
77	A20-160004-1	Tension Arm Spacer	1
78	G13-202516	Needle Bearing, IR202516	2
79	G10-253216	Needle Bearing, HK2516	2
80	A20-164150	Tension Adjuster	1
81	A20-162001A	Tension Jaw (PET)	1
	A20-162001	Tension Jaw (PP)	1
82	G01-081008	Metal Bush, MB0808	2
83	A20-120005-1	Slide Table Stopper	1
84	A20-165003	Spring Hook	1
85	A20-160003	Tension Adjust Spring	1
87	A20-163003	Plate (Tension Select Dial)	1
88	A20-410003	LH Bandway Stop Spring	1
89	A20-163004	Tension Adjust Cam Spring	1
90	A20-163002-1	Tension Adjust Shaft	1
91	A20-163009	Tension Indicated Arm	1
92	A20-163005	Tension Adjust Cam Lock	1
93	A20-120012	Slide Table Tension Spring	1
94	A20-120011	Slide Table Spring Hook	1
95	A20-160002	Tension Arm Spring	1
96	A20-160006-1	Tension Arm Spring Hook L-Type	1
97	A20-173001	Upper Adjust Base	1
98	A20-173002	Upper Adjust Spring Hook	1
99	A20-173004	Upper Adjust Spring	1
100	A20-173003	Upper Adjust Spring Rod	1
108	A93-112000	Gear Box	1
	A93-112000B	Gear Box (30 Strapping/minute)	1
109	E21-010002S	Stator (111-06-13S B-S50 24V11W)	1
	E21-010004S	Stator (FBD-1.2 24V 15W)	1
110	A20-110007R1A	Gear Box Pulley Assembly(11W)	1
	A20-110016A	Gear Box Pulley Assembly(15W)	1